



Datasheet

Submersible level transmitter

SUP-P260-M2

Supmea[®]

Committed to process automation solutions

Tel: 86-15158063876

E-mail: info@supmea.com

www.supmea.com

Datasheet

The submersible Level Transmitter is designed for difficult level sensing applications where sludge, slurry, or turbulence may be present. The transmitter provide continuous liquid level measurement by sensing the hydrostatic pressure produced by the height of liquid above the sensor and providing a 4-20 mA output signal compatible with PLC, panel meter, data logger, and other electronic equipment. The transmitter consists of a sensing element, encased in a 316 SS housing with cage and large diameter 316 SS diaphragm seal. The sensor prevents moisture intrusion, and performance well even when the assembly is buried in a layer of sludge or slurry.

Application

- Wastewater
- Wet Wells
- Oil tanks
- Sumps
- Reservoirs
- Sludge, slurry or turbulence
- Chemical storage tanks
- Lift station monitoring
- Liquid level in vented tank
- Landfill leachate monitoring
- Dewatering
- Pump control

Features

- Non-clogging and damage resistant to floating solids
- Durable 316 SS construction for reliable, long life in harsh environments
- 1/2 inch NPT threaded connection, allows the unit to be installed in a pipe/conduit
- Diaphragm is protected from physical damage and turbulence
- Added weight helps hold transmitter in place
- Excellent chemical compatibility for wide application use



Submersible level transmitter

Parameter
Relative pressure

bar	0...0.25	0...0.4	0...0.6	0...1	0...1.6	0...2.5	0...4	0...6	0...10
mH2O	0...2.5	0...4	0...6	0...10	0...16	0...25	0...40	0...60	0...100
psi	0...3.6	0...5.8	0...7.8	0...14.5	0...23.2	0...36.2	0...58	0...87	0...145

The given measuring ranges are also available in mbar, kPa and MPa.

Medium	Compatible liquids
Measure range	0m-0.5m-100m
Overload pressure	≤200%FS
Pressure type	G (surface pressure)
Accuracy	0.5%
Stability	±0.2%FS/Year
Zero temperature drift	±0.03%FS/°C
Sensitivity drift	±0.03%FS/°C
Temp compensation	0°C-50°C, -10°C-60°C
Medium temperature	-30°C-65°C
Power supply	12VDC-30VDC
Signal output	4mA-20mA,0V-5V(Customized)
Load Resistance	Current type: ≤ (U-12) /0.02(Ω)
Ingress protection	IP68

Electrical connection
Cable lengths

Meter (m)	1.5	3	5	10	15	20	25	30	40	50	60	80	100
Feet (ft)	5	10	20	30	40	50							

Other cable lengths on request

Wiring diagrams

2-wire-system (current)

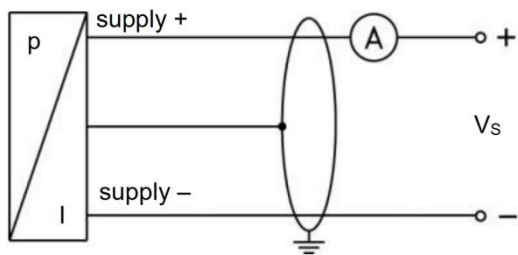

3-wire-system (voltage)

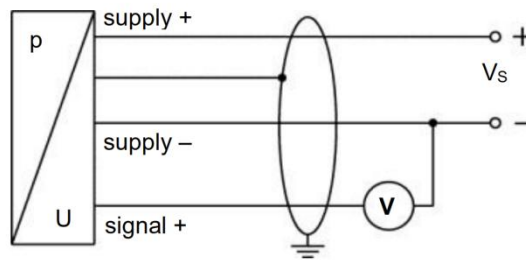

Current output:

- Red: 24V +
- Green: Current +
- Black: GND

Voltage output:

- Red: 24V +
- Green: 24V -
- Yellow: Voltage +
- Black: GND

RS485 output:

- Red: 24V +
- Green: 24V -
- Yellow: 485A
- Blue: 485B
- Black: GND

Dimension

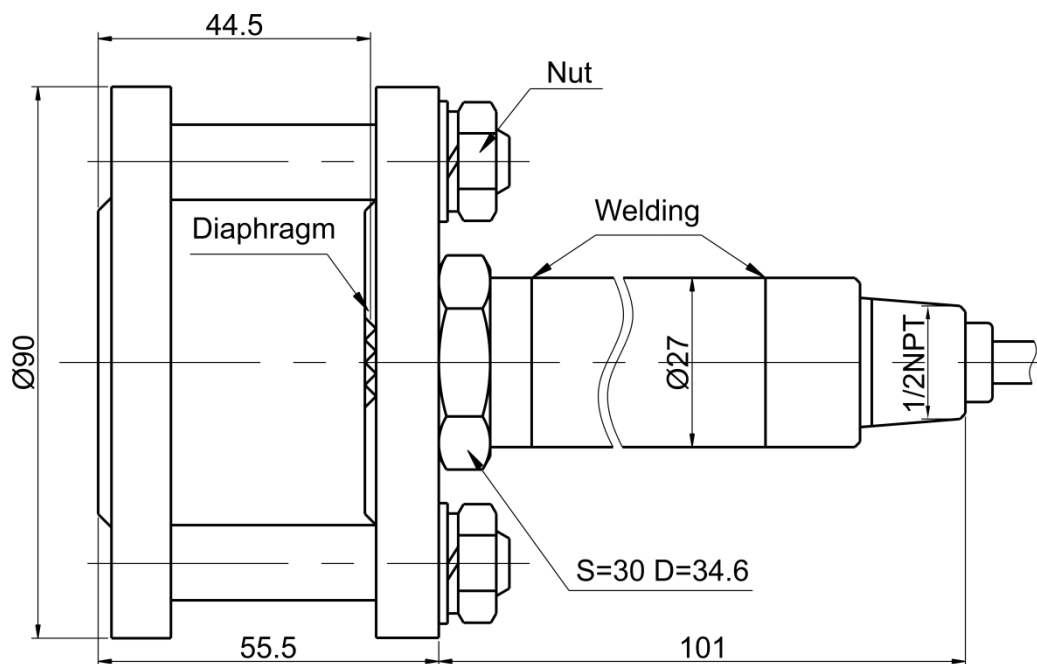

Ordering code

SUP-P260-M2-03-K-A1-M3-1-20-N9											Description	
SUP-P260-M2	-	-	-	-	-	-	-	-	-	-	-	3m(With weight block)
	03											5m
	05											7m
Measurement	10											10m
Range	20											20m
	50											50m
	1H											100m
	XX											Other
		K										0.5 Class
Accuracy		G										0.25 Class(Only range $\geq 10m$)
		X										Other
			A1									Two-wire 4-20mA
			V1									0-5V,24VDC
Output and Power Supply			V2									0-10V,24VDC
			R2									RS485,24VDC
			R1									RS485,12VDC
			XX									Other
Diaphragm Material				M3								SS316L
				XX								Other
Probe Material and Ingress Protection					1							304SS,IP68
					2							SS316L,IP68
					X							Other
						05						5m
Cable Length						10						10m
(Recommended cable length \geq measurement range)						20						20m
						50						50m
						1H						100m
						XX						Other
Cable Sheath Material							N9					Polyvinyl Chloride
							N2					Polyurethane
							XX					Other

Accessories

Data logger

Panel meter

Panel meter

